

SONOSCALE ASK200

Order number: 100010223

Technical Data:

Operating frequency:	200 kHz \pm 4 %
Beam width (-3 dB):	12° \pm 2°
Max. driving voltage at 2 % duty cycle tone burst:	500 V _{pp}
Min. transmit sensitivity at optimal transmit frequency:	102 dB re 1 μ Pa/V at 1 m
Min. receive sensitivity at optimal receive frequency:	-180 dB re 1 V/ μ Pa
Capacitance (1 kHz):	530 \pm 100 pF
Weight:	6 g
Operating temperature:	-40 to +90 °C
Housing:	PVDF
Acoustic window:	PVDF

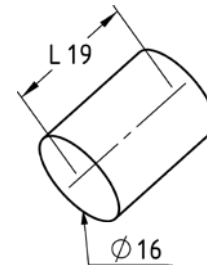

Technical specifications may be changed by SONOTEC without further notice.

Transmit and Receive Voltage Response:

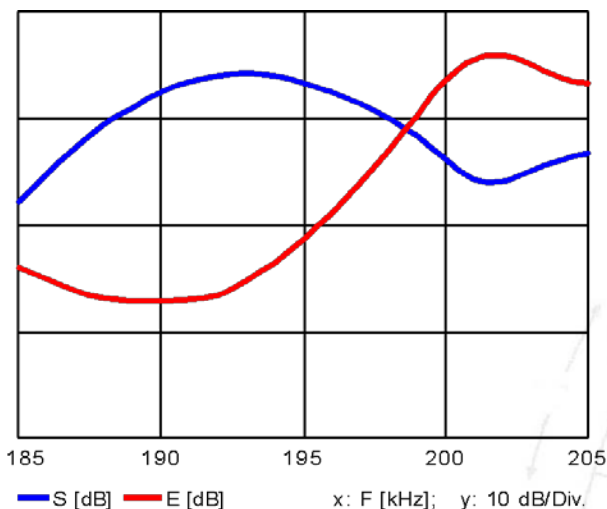

Directivity Pattern:

